



MACALESTER COLLEGE



**DARWIN'S GALAPAGOS ISLANDS & HACIENDAS, MARKETS & VOLCANOES OF ECUADOR**



# DARWIN'S GALAPAGOS ISLANDS & HACIENDAS, MARKETS & VOLCANOES OF ECUADOR

**DATES: JAN 30<sup>TH</sup> - FEB 10<sup>TH</sup>, 2015**

**TRIP PRICE: \$5,320**

(AIRFARE NOT INCLUDED)

**THE MACALESTER COLLEGE ALUMNI ASSOCIATION** in conjunction with Knowmad Adventures is proud to announce an incredible group trip "Darwin's Galapagos Islands and Haciendas, Markets and Volcanoes of Ecuador." This twelve-day trip will highlight incredible Andean landscapes and fascinating indigenous cultures in mainland Ecuador and includes a luxurious 6-day small ship cruise around Darwin's Galapagos Islands which are full of fascinating endemic species and beautiful volcanic landscapes. Join Director of Alumni Relations Gabrielle Lawrence along with excellent local guides and naturalists as we take the path less traveled for an authentic Ecuador experience and a high-quality expedition cruise in the Galapagos!

## HIGHLIGHTS OF THE TRIP

- Cruise the Galapagos Islands aboard a luxury class yacht with less than 100 passengers
- Enjoy naturalist-led excursions to discover myriad endemic species and unique landscapes
- Explore Quito, Ecuador's capital and a UNESCO World Heritage site for its striking colonial architecture
- Explore some of the most beautiful sections of the Andes Mountains and walk to a gorgeous volcanic crater lake
- Enjoy lavish meals at historic haciendas (ranch properties)
- Visit Julio Toaquiza's ceramic workshop and learn of highland folklore
- Tour a rose plantation
- Browse and shop in an authentic indigenous market well off the beaten path
- Meet Andean chagras (cowboys) and learn about their fascinating history and culture
- Do it in style! This luxurious adventure highlights carefully selected accommodations in a variety of settings such as restored colonial mansions, a working ranch and an expedition yacht
- Trip escorted by Alumni Relations Director Gabrielle Lawrence and Knowmad co-Founder Jordan Harvey
- Travel in a small group of less than 25



**DAY 1- 4** U.S.A – Quito – Haciendas, Volcanoes, and Indigenous Cultures of Central Andes

**DAY 4-6** Quito

**DAY 6-11** Galapagos Islands Cruise

**DAY 12** Home



MAP OF SOUTH AMERICA

JAN 30 Depart Minneapolis, Minnesota or your hometown

A recommended flight will be supplied closer to travel time. Upon arriving most likely in the late evening, the group will be met and transferred to your accommodations situated in the historic district of Quito.

- No meals – Patio Andaluz or similar

JAN 31 Quito – Cotopaxi Volcano

Setting out after breakfast we'll head south through the city and down the valley below Pichincha. Enshrouded by clouds, the valleys of the famed Avenue of the Volcanoes open up as massive Cotopaxi (meaning 'neck of the moon' in the ancient tongue) comes into view. Our first visit will be at Nevado Roses, a flower plantation where we will tour the facilities learning about flower cultivation and exportation in Ecuador, one of the world's predominant rose exporters. After a delicious lunch we'll visit the stunning Quillotoa Crater where we'll take a relaxing walk down to the shores of the dazzling, emerald-green lagoon at the crater's center. This is a true natural wonder. From here we will return back up by foot or horseback to enjoy the view. We will then visit a nearby indigenous community to learn about the areas culture and lifestyle before continuing on to the ever so charming Hacienda Alegria for dinner and a relaxing evening.

- B, L, D – Hacienda Alegria or similar

FEB 1 Cotopaxi Area

Driving out into Andean countryside we'll pass sheep and lamas grazing before arriving to the highland town of Pujili and La Victoria which are renowned for their artisanal ceramics. Our first visit will be to the bustling, off the beaten path market of Pujili. We'll then visit a local ceramics workshop to see their ancient production techniques and final products. You'll also have a chance to create your own ceramic memory. In Tigua we'll visit local artist Julio Toaquiza's workshop where he paints colorful scenes of highland festivals and folkloric characters typical of the region on sheep skin in the naïf style. Having worked up an appetite we'll visit a charming local restaurant before returning to the hacienda for a chagra show.

The introduction of cattle and bulls into the Andean highlands by the Jesuits gave birth to a rich cultural phenomenal still iconic of the region today; the chagras, or Andean cowboys. Chagras were the first indigenous groups at the time allowed to ride horses and for centuries the chagras have carved out a unique and enviable identity in the region.

- B, L, D – Hacienda Alegria or similar

FEB 2 Cotopaxi – Antisana – Quito

After a filling breakfast we head south through the main square at Pintag where you'll learn about the clash of the Inca and Caranqui civilizations. After a taste of exotic local fruits like cherimoya we'll arrive to some of the best preserved paramo, or highland moor, in the world. As we wind our way up through the paramo, a relatively young lava flow path will lead us up to the Antisana Volcano and what used to be the famous Hacienda Antisana. We will leave the bus at Antisana River Gorge, a small high-altitude stream of glacial melt from the volcanoes glacier. We will enjoy an hour or so walk north past the base of Chuzalongos, three peaks formed by an ancient horseshoe crater and named after an indigenous legend speaking of mountain goblins.

Walking to seasonal lake Santa Lucia it is possible to see highland animals and the great Andean condor. Enjoy a box lunch during this hike before returning to the van. We will then make the hour and a half drive back to Quito.

- B, L, D – Patio Andaluz or similar

FEB 3 Quito

Step back in time walking through picturesque neighborhoods of quaint cobble-stoned streets lined with colorful colonial houses en route to the historic town center where our first stop is La Basilica, a fascinating architectural building. Continuing on we pass The Seven Crosses Street, an important Inca route from times past that was transformed with the arrival of the Spaniards and

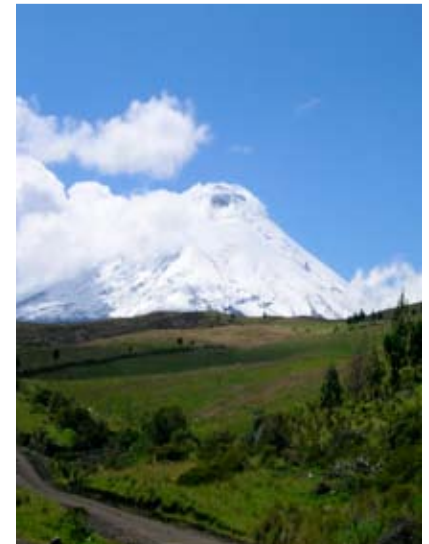

Christianity. From here we arrive to the cities central Independence Plaza lined with the oldest cathedrals in South America and the sacred heart of the city: La Catedral de Quito. Here we see the Presidential Palace, the Metropolitan Cultural Center, a museum home to a great oil paint collection, and more. Enjoy lunch on this historic plaza.

Following lunch those who still have energy will head just north of the city to visit the Middle of the World complex where the equator runs. You'll have the unusual opportunity of straddling both hemispheres. We'll also visit the nearby Intinan Museum dedicated to the promotion and study of the cultures inhabiting the nearby areas.

- B, L, D – Patio Andaluz or similar

FEB 4 Quito – Galapagos

#### MV SANTA CRUZ

With a capacity of 90 guests in 43 cabins, the MV Santa Cruz is large enough to provide a calm ride and a range of amenities, yet small enough for an intimate feel and minimal environmental impact. Some ship highlights are air-conditioning throughout, a glass-bottom boat available for excursions, some of the islands best naturalist guides, and gourmet cuisine. All excursions, meals, and lectures while cruising are included in your trip cost. For more ship details please see ship specifications page.

Following breakfast we transfer to the airport in accordance with our flight to the Galapagos Islands, approximately 2 hours west into the Pacific where we will board the MV Santa Cruz for a 6-day cruise through the Galapagos Islands. During this cruise we will enjoy naturalist-led walks amongst a variety of islands as we discover the unique animal and plant life that helped inspire Darwin's Theory of Evolution.

Afternoon – North Seymour Island

This is a great introductory site to the islands and their wildlife, full of bird colonies of blue footed boobies, two species of frigate birds, swallow tailed gulls, as well as sea lions and marine iguanas.

- B, L, D – MV Santa Cruz

FEB 5 Galapagos

Morning – Punta Vicente Roca – Isabela Island

After breakfast, we explore the coast by panga (local word for small zodiac), while our naturalist guide explains the dramatic geology of the area, nesting place for a Galápagos highlight: flightless cormorants. Depending on weather conditions, we can snorkel along the cliffs of this area rich in marine life, seasonally-visited by green sea turtles and oceanic sun fish (Mola mola).

Afternoon – Espinoza Point - Fernandina Island

The afternoon is dedicated to exploring the youngest island of the archipelago, Fernandina, which, having no introduced mammals, boasts a very unique environment with a very high density of marine iguanas, who share their space with sea lions, Sally light-foot crabs, hawks, penguins and the flightless cormorants.

- B, L, D – MV Santa Cruz

FEB 6 Galapagos

Morning - Tagus Cove - Isabela Island

After breakfast, we land at this cove on the northwest of Isabela. It provided a favourite anchorage for pirates and whalers over the centuries. An uphill hike takes guests to the rim of a crater, Darwin Lake, filled with salt water and to a dramatic viewpoint. After our walk, we take a panga ride to spot local wildlife, with the possibility of swimming or snorkelling.

Afternoon – Urbina Bay – Isabela Island

After lunch we disembark at Urbina Bay, the fascinating result of an uplifting of the ocean in 1954. Here we can admire corals, shells and many other calcareous organisms exposed above



## ITINERARY CONTINUED: DARWIN'S GALAPAGOS ISLANDS & HACIENDAS, MARKETS & VOLCANOES OF ECUADOR

water. First we enjoy a snorkel from the beach, with the chance of swimming with flightless cormorants and penguins. This area is also home to a large and very colourful Galápagos land iguanas, and occasionally to giant tortoises. We return back on board for our expedition plan for Saturday and dinner.

- B, L, D – MV Santa Cruz

### FEB 7 Galapagos

Morning - Puerto Ayora and the Charles Darwin Research Station - Santa Cruz Island  
Disembark for our visit to the Charles Darwin Research Station's giant tortoise breeding center within an impressive giant prickly-pear cactus forest home to many land birds. These are the headquarters of scientific investigation, conservation and the National Park administration. Following our visit, we board our transport to enjoy lunch in the cooler highlands of Santa Cruz Island, a completely different ecosystem.

#### Afternoon - Santa Cruz Island

We have several options available for the afternoon, which can be discussed in advance with your Expedition Leader. At the end of the afternoon's activities, we return to Puerto Ayora and embark on the Santa Cruz.

- B, L, D – MV Santa Cruz

### FEB 8 Galapagos

#### Morning - Post Office Bay and Baroness Cove - Floreana Island

A short walk leads us to the historic barrel where postcards are traditionally left for guests from other vessels to hand-deliver to their destinations. Near Post Office Bay, we explore the north shore of Floreana along narrow channels teeming with life. Another short walk takes us to Baroness Cove where all will be revealed about the fascinating "murder mystery" on Floreana. Swimming and snorkeling off the beach is a good option. We then head back on board for lunch.

#### Afternoon - Champion Islet and Cormorant Point - Floreana Island

Following lunch and a siesta, we take to the pangas and glass-bottom boat to explore the underwater wonders around Champion Islet, an extinct shield volcano, regarded as one of the best snorkeling spots in the archipelago. From there, it's on to Cormorant Point, beginning with a landing on the olivine-crystal beach for an easy walk that includes a brackish water lagoon where bird species such as greater flamingos, pintail ducks, common stilts, herons, sandpipers, and others gather. We continue our walk over to a white-sand beach, where sea turtles emerge from the sea at night to nest (from December to May).

- B, L, D – MV Santa Cruz

### FEB 9 Galapagos – Quito – Onward Home

We disembark at Baltra Island in order to transfer to the airport to take the flight back to the mainland. After arriving to the mainland we will go just a short distance from the airport to a nice hacienda to enjoy the grounds and a farewell meal before returning to the airport to catch our late-evening overnight flight.

(B, D)

- B, D



### IMPORTANT NOTE

- *Please remember that the exact route and programme may vary according to weather and ocean conditions and the wildlife we encounter.*
- *Itineraries and programme are subject to change without previous notice due mainly to readjustment of the National Park policies and regulations, weather conditions, seasonal changes or safety reasons.*

### INFORMATION ABOUT THE GALAPAGOS ISLANDS

Great things come in little packages. This very popular saying is one of the best ways to describe what the Galapagos Islands has to offer. A group of tiny volcanic islands that sit just off the equator, the Galapagos has for centuries, captured the interest of people from all over the globe. Important from a scientific viewpoint, as these islands were instrumental in Darwin's Theory of Evolution, the Galapagos today, is a nature wonderland.

Located 1,000 km off the coast of Ecuador, these islands let you get up close and personal with nature. The Galapagos is indeed a must visit destination if you are interested in a wildlife vacation. An archipelago of 19 islands of varying size and a number of islets, these islands are the perfect place to see nature at its very best. Here, the animals roam around free and unafraid, due to the lack of any natural predators, giving you plenty opportunity to capture them with your camera.

Over five million years old, the Galapagos today is one of the perfect places to see nature in action. Often referred to as the 'laboratory of evolution,' these islands are now playing a tremendous role in helping us to understand our planet much better.

### VISITING THE GALAPAGOS IN FEBRUARY

There is never a bad time to visit the Galapagos. December through May has slightly warmer than average temperatures (78 ° F daytime average highs) and it generally drizzles a bit at some point in the day, however it is also the sunniest time of year with rain clouds moving on quickly. The water is warmer during this time of year making swimming and snorkeling more comfortable, however there aren't quite as many fish as other times of year. December through May is the breeding season for land birds, so it's a great time to see unusual mating rituals. Sea lions also mate in this season and males can be seen sparring. The other benefits of this season are much calmer seas and blooming flowers making the islands their most colorful.

### DRY AND WET LANDINGS

- *Dry landing: guests step from the dinghy onto rocks or a dock.*
- *Wet landing: as the dinghy edges onto a sandy beach, guests step into knee-deep water and wade ashore.*

**ACCOMMODATION HIGHLIGHTS**

\*These are the preferred accommodations but are subject to change based on availability at time of trip confirmation.

**PATIO ANDALUZ: QUITO, ECUADOR MAINLAND**



**HACIENDA ALEGRIA: AVENUE OF THE VOLCANOES, ECUADOR MAINLAND**



**MV SANTA CRUZ: GALAPAGOS ISLANDS, ECUADOR**



The 90-guest M/V Santa Cruz has a fun, informal and relaxed atmosphere and is ready to give its passengers an experience of the Galápagos Islands they'll never forget!

**Sun Deck**

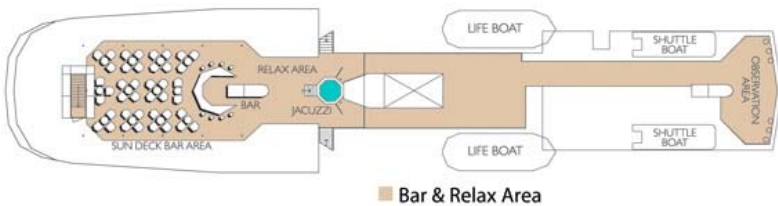

**Upper Deck**

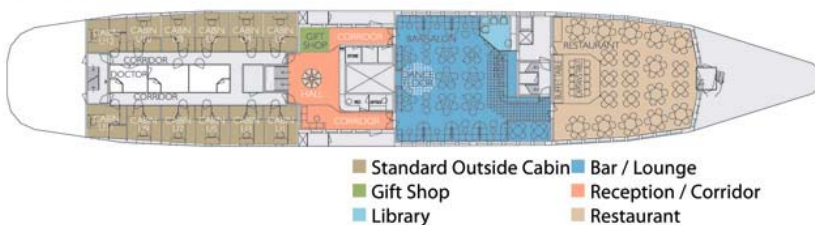

**SHIP FACILITIES:**

- Bar-Lounge, Dining room
- Gift shop
- Coffee station (coffee, tea and water 24 hours-a-day)
- Satellite telephone
- Intermittent and low-bandwidth internet service
- PA system
- Snorkelling equipment
- Hair dryer, speakers for iPod/MP3 Players and safe deposit box in each cabin
- Hot Tub
- Reading Room and Natural History Library
- Air conditioned throughout
- Wet suits for hire
- Glass-bottom boat



**ACCOMMODATION HIGHLIGHTS CONTINUED: MV SANTA CRUZ ROOM CATEGORIES**

The MV Santa Cruz has three decks, from Master Suites to StandardCabins, offering a wide range of accommodation. The main deck standard cabin, the uppder deck twin standard, and the boat deck twin standard double are detailed below. For pricing and availability of boat deck superior, suite, and master suite please inquire.

**MAIN DECK STANDARD CABIN**  
Included in itinerary price.

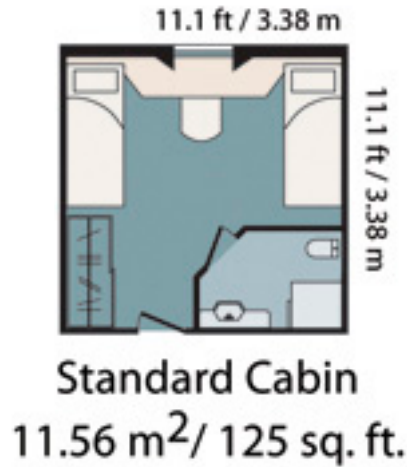

**UPPER DECK TWIN STANDARD**  
Add \$160 per person



**BOAT DECK STANDARD DOUBLE**  
Add \$460 per person

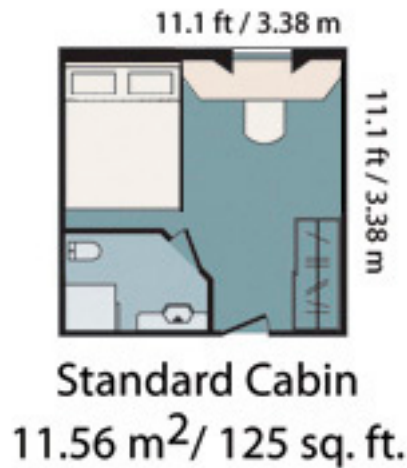

## COST DETAILS

---

\$5,320\* Land cost per traveler, double occupancy, main deck standard cabin.

*Upper deck twin standard: add \$160 per person*

*Boat deck twin standard double: add \$460 per person*

*For pricing and availability of boat deck superior, suite, and master suite please inquire.*

\$2,025 Single supplement. May be more depending on cruise cabin category. High single supplement due to singles paying a 50% surcharge on cruise rate. We are happy to pair you with an excellent roommate for the trip to avoid this cost!

\$1,550\*\* Estimated airfare costs. It is estimated international air on Delta will be around \$1,000, and Galapagos air at \$550.

\*Note: As currency exchanges and fluctuations vary, this is an approximate cost, which Knowmad Adventures reserves the right to adjust. Tour price based on minimum 12 travelers. Knowmad reserves the right to adjust this price in order to accommodate fewer registrants should there be less than 12. Trip size is capped at 25.

\*\*Knowmad Adventures will assist in arranging your airfare within Ecuador and you will be invoiced based on the price at the time of booking (estimated \$550 USD). They will also assist you in arranging your international airfare on the suggested flights, but are not responsible if available flights exceed the price estimate, or you may purchase independently. Please contact Knowmad prior to purchasing international airfare however to be sure your arrival and departure schedule comply with the trip.

### WHAT YOUR TRIP COST INCLUDES

Pre-trip services: Trip Information Packet (contains a pack list & details about regions, weather, electricity, etc.) and personalized pre-departure support

5 nights deluxe and boutique hotel accommodations

6 day Galapagos cruise aboard MV Santa Cruise

Professional English-speaking guides throughout

11 breakfasts, 10 lunches and 10 dinners

Local excursions as indicated

Airport transfers as indicated

Backcountry field arrangements as necessary

Ground transportation and support vehicles

Additional guides and porters as needed

Escorted by Alumni Relations Director Gabrielle Lawrence and Knowmad co-Founder Jordan Harvey

Entrance fees and permits other than those specified below

Taxes and surcharges while on the tour

### WHAT YOUR TRIP COST DOES NOT INCLUDE

International and domestic airfare (see estimates for airfare cost guidance)

Visa, passport, departure/arrival and excess baggage fees

Galapagos National Park Protected Area Entrance Fee (\$100 per person)

Trip insurance (trip insurance including cancellation coverage strongly recommended)

Activities listed as optional and/or denoted with asterisk

Meals not indicated in the itinerary

Tips to local guides, staff, and cruise ship crew

Personal items

Alcoholic beverages, some non-alcoholic beverages on cruise

## PAYMENT SCHEDULE

---

DUE UPON RESERVATION

\$1,000 deposit per traveler

75 DAYS PRIOR TO DEPARTURE

Remaining Balance

PLEASE REFER TO REGISTRATION FORM FOR TERMS & CONDITIONS

## READY FOR THE TRIP OF A LIFETIME?

Signing up is easy. Call us at 1-877-616-8747 and reserve your spot. Or simply fill out the Registration & Payment Forms, read & sign the Booking Information & Liability Release, and mail, fax or email pages 1-3 of this document to Knowmad Adventures (see page 2 for contact info). We thank you for choosing to explore with Knowmad Adventures.



## REGISTRATION FORM

If you're more than 2 travelers, download additional forms at [www.KnowmadAdventures.com/contact.html](http://www.KnowmadAdventures.com/contact.html). Please print clearly in blue or black pen.

TRIP NAME \_\_\_\_\_ START DATE \_\_\_\_\_

**TRAVELER ONE** NAME (Important: exactly as it appears on passport) \_\_\_\_\_

STREET ADDRESS \_\_\_\_\_

CITY \_\_\_\_\_ STATE \_\_\_\_\_ ZIP \_\_\_\_\_

PHONE \_\_\_\_\_ EMAIL \_\_\_\_\_

GENDER  male  female BIRTHDAY (mm/dd/yyyy) \_\_\_\_\_ OCCUPATION \_\_\_\_\_

PASSPORT NO. \_\_\_\_\_ EXPIRATION DATE \_\_\_\_\_ CITIZENSHIP \_\_\_\_\_

MEDICAL CONDITIONS/ALLERGIES \_\_\_\_\_ DIETARY RESTRICTIONS \_\_\_\_\_

EMERGENCY CONTACT \_\_\_\_\_ PHONE \_\_\_\_\_

**ACCOMMODATION INFO** I will share accommodations with \_\_\_\_\_ We prefer  2 twin beds  1 bed

I am a single traveler  yes  no If available, assign me a roommate  yes  no

**TRAVELER TWO** NAME (Important: exactly as it appears on passport) \_\_\_\_\_

STREET ADDRESS \_\_\_\_\_

CITY \_\_\_\_\_ STATE \_\_\_\_\_ ZIP \_\_\_\_\_

PHONE \_\_\_\_\_ EMAIL \_\_\_\_\_

GENDER  male  female BIRTHDAY (mm/dd/yyyy) \_\_\_\_\_ OCCUPATION \_\_\_\_\_

PASSPORT NO. \_\_\_\_\_ EXPIRATION DATE \_\_\_\_\_ CITIZENSHIP \_\_\_\_\_

MEDICAL CONDITIONS/ALLERGIES \_\_\_\_\_ DIETARY RESTRICTIONS \_\_\_\_\_

EMERGENCY CONTACT \_\_\_\_\_ PHONE \_\_\_\_\_

**ACCOMMODATION INFO** I will share accommodations with \_\_\_\_\_ We prefer  2 twin beds  1 bed

I am a single traveler  yes  no If available, assign me a roommate  yes  no



## PAYMENT FORM

In order to make a reservation for your trip please fill out the Registration Form on page 1, read the Booking Information and Liability Release, signing on page 3, fill in your deposit payment method below, and sign the Insurance section at the bottom of this page. Mail pages 1 - 3 to Knowmad Adventures, PO Box 50572, Minneapolis, MN 55405. If your trip departs soon and availability may be an issue, please scan and email forms to [travel@knowmadadventures.com](mailto:travel@knowmadadventures.com) or fax to 1 612 293 3935. NOTE >> Never email credit card information. If paying by credit card and emailing the forms please sign below, but call us at 1 877 616 8747 to give your card number and additional information verbally. We thank you and look forward to traveling together.

### DEPOSIT PAYMENT METHOD

PERSONAL CHECK OR MONEY ORDER

CREDIT CARD     Visa     Mastercard     Discover

CARD NUMBER

EXPIRATION DATE

3/4 DIGIT SECURITY CODE (on back of card)

□	□	□	□	□	□	□	□	□	□	□	□	□	□	□	□	/	□	□	□	□	□	□
---	---	---	---	---	---	---	---	---	---	---	---	---	---	---	---	---	---	---	---	---	---	---

BILLING ADDRESS     Same as address listed on Registration Form.    If different, please list below.

STREET ADDRESS \_\_\_\_\_

CITY \_\_\_\_\_ STATE \_\_\_\_\_ ZIP \_\_\_\_\_

CREDIT CARD AUTHORIZATION SIGNATURE \_\_\_\_\_ DATE \_\_\_\_\_

NAME AS IT APPEARS ON CREDIT CARD \_\_\_\_\_

\$1,000 USD MULTIPLIED BY NO. OF TRAVELERS = \_\_\_\_\_ TOTAL DEPOSIT AMOUNT IN USD

>> Note that the above deposit amount is for Classic Knowmad Itineraries and some Custom Itineraries. If your trip is custom please refer to your proposal for specific deposit amount.

>> PLEASE READ THE LIABILITY RELEASE & BOOKING INFORMATION, AND SIGN ON PAGE 3.

### INSURANCE

All travelers with Knowmad Adventures are required to be covered by travel related personal medical insurance. I agree to obtain or verify that I have the above personal medical insurance. Baggage and cancellation insurance are also highly recommended (ask us about supplemental insurance). If you choose to decline this protection, you are assuming any financial loss associated with your travel arrangements.

SIGNATURE OF TRAVELER ONE \_\_\_\_\_ DATE \_\_\_\_\_  
Parents and/or Legal Guardians must sign for participants under the age of 18

SIGNATURE OF TRAVELER TWO \_\_\_\_\_ DATE \_\_\_\_\_  
Parents and/or Legal Guardians must sign for participants under the age of 18

### PAPER FREE

In an effort to create a little less waste in our planet, it is our standard procedure to send your itinerary, trip information packet, and all related materials by email. If you prefer that we send paper copies of these documents by post mail, simply check the box below.

I would like paper copies of my Knowmad documents mailed to me.

### FOR OFFICE USE ONLY

FOLDER OR GROUP NAME \_\_\_\_\_

TRAVEL DATES \_\_\_\_\_

TOTAL PAX # \_\_\_\_\_ PAX # FOR THIS PMT ONLY \_\_\_\_\_

NAME(S) FOR THIS PMT ONLY:  
 \_\_\_\_\_  
 \_\_\_\_\_

PAYMENT TYPE     Credit Card     Check

(WITH CC) A1 \_\_\_\_\_ ZIP \_\_\_\_\_

TOTAL TO PROCESS (Detail Above) \_\_\_\_\_

DATE FORMS RECEIVED (For Insurance) \_\_\_\_\_

## LIABILITY RELEASE

*This Agreement is important. It includes terms and conditions and releases Knowmad Adventures, Inc., doing business as Knowmad Adventures and Macalester College in the role of trip sponsor, from liability. It must be signed by all participants.*

### RELEASE FROM LIABILITY.

Knowmad Adventures, Inc., is defined to include its employees, shareholders, subsidiaries, affiliates, officers, directors, representatives and agents. Macalester College in the role of trip sponsor is not legally liable for any negligent or willful act or failure to act of any person or entity related to travel arrangements made through Knowmad Adventures. Neither Macalester College nor Knowmad Adventures Inc. owns or operate any entity which provides goods or services for your trip including, for example, lodging facilities, bus, plane, train, kayak, yacht or other transportation companies or devices, food service providers, equipment suppliers, etc. All such persons and entities are independent contractors. As a result, Knowmad Adventures, Inc. and the trip sponsor, are not liable for any negligent or willful act or failure to act of any such person or entity, or of any other third party. Without limitation, Knowmad Adventures, Inc. and the trip sponsor, are not

responsible for any injury, loss, or damage to person or property, death, delay or inconvenience in connection with the provision of any goods or services occasioned by or resulting from, but not limited to, acts of God, acts of government, force majeure, acts of war or civil unrest, insurrection or revolt, strikes or other labor activities, criminal or terrorist activities of any kind, or the threat thereof, overbooking or downgrading of accommodations, structural or other defective conditions in hotels or other lodging facilities, mechanical or other failure of airplanes or other means of any sort, dangers incident to recreational activities such as swimming, kayaking, canoeing, rafting, hiking, horseback riding, bicycling, rock climbing, etc., sanitation problems, food poisoning, lack of access to or quality of medical care, difficulty in evacuation in case of a medical or other emergency, illness, epidemics or the threat thereof or for any other cause beyond the direct control of Knowmad Adventures, Inc. or associated sponsors. In addition, I release Knowmad Adventures, Inc. and its sponsors, from its own negligence and assume all risk thereof.

Knowmad Adventures, Inc., may take photographs or video of its trips and trip participants grant Knowmad Adventures, Inc. permission to do so and for it to use them for promotional or com-

mercial use without payment or any compensation to participant.

### ASSUMPTION OF RISK.

I am aware that adventure travel such as that I am undertaking involves hazardous activities, some in remote areas of the world, with a risk of illness, injury or death which may be caused by forces of nature, the negligence of Knowmad Adventures, Inc., or other persons and companies known or unknown, or of willful or criminal conduct of third parties. I am aware that weather conditions may be severe, adverse and/or unpleasant. I am also aware that medical services or facilities may not be readily available or accessible during some or all of the time during which I am participating on the trip. In order to partake of the enjoyment and excitement of this adventure travel trip I am willing to accept the risks and uncertainty involved as being an integral part of my adventure. I hereby accept and assume full responsibility for any and all risks of illness, injury or death and of the negligence of Knowmad Adventures, Inc., or of any third parties.

### VOLUNTARY PARTICIPATION.

I acknowledge that I have voluntarily applied to participate on the trip designated on this

application (or a trip which I may change to). I am voluntarily participating in this trip with knowledge of the hazards involved.

**ARBITRATION.** I agree that in the unlikely event of any dispute concerning, relating, or referring to this contract, the brochure, or any other literature concerning my trip, or the trip itself shall be resolved exclusively by binding arbitration in Minneapolis, Minnesota according to the then existing commercial rules of the American Arbitration Association. Such proceedings will be governed by substantive Minnesota law. Should any part of this contract be found invalid or not enforceable by a court of law, then the remaining portion shall continue to be valid and in force.

**KNOWING AND VOLUNTARY EXECUTION.** I have carefully read this agreement including the Booking Information sections on pages 4 and 5 of this document, especially those regarding cancellation and refund policies, limitation of liability, and responsibility borne by trip participants. I am aware that this is a release of liability and a contract between myself and Knowmad Adventures, Inc., and sign it of my own free will.

SIGNATURE OF TRAVELER ONE

Parents and/or Legal Guardians must sign for participants under the age of 18

DATE

SIGNATURE OF TRAVELER TWO

Parents and/or Legal Guardians must sign for participants under the age of 18

DATE

## BOOKING INFORMATION

### WHAT YOUR TRIP INCLUDES

- Pre-trip services
- Expert leadership and guiding
- Accommodations as indicated in detailed itinerary and based on double occupancy
- Local excursions as indicated
- Airport transfers as indicated in detailed itinerary
- Backcountry field arrangements as necessary
- All necessary equipment for adventure excursions
- Ground transportation and support vehicles
- Additional guides and porters as needed
- Entrance fees and permits
- Alcohol as indicated on select itineraries
- All meals as indicated in detailed itinerary (B-breakfast, L-lunch, D-dinner)

Each trip varies slightly, so call 1-877-616-8747 to speak with us or visit [www.KnowmadAdventures.com](http://www.KnowmadAdventures.com) to download detailed itineraries.

### WHAT ISN'T INCLUDED

- International and domestic airfare unless otherwise indicated (our travel experts can help you arrange your flights, but airfare is a separate cost)
- Visa, passport, departure/arrival and excess baggage fees
- Trip insurance
- Activities denoted by an asterisk and listed as optional
- Personal items

### TIER PRICING

Trip prices listed in our catalog are based on a minimum group size of four. Please inquire about pricing for smaller groups.

### SINGLE SUPPLEMENT

Accommodations are based on double occupancy. If you prefer single accommodations you must pay a single supplement fee, which is listed in the trip itinerary. If you are traveling alone and wish to share accommodations, we will try our best to find you a roommate of the same gender. Should no one be available at the time you register, the Single Supplement is payable and you will be invoiced accordingly. If a roommate is found prior to departure, this fee will be refunded.

### BOOKING AND PAYMENT SCHEDULE

A \$1,000 deposit, along with the signed and completed Registration Form will reserve your Knowmad Adventures trip.

### Payment Schedule as Follows

Time of reservation	\$1,000
75 days prior to departure	Balance

Payment can be made in the form of credit card, cash, check, money order or bank transfer. If your trip departs within 15 days of booking, payment is required by credit card in full.

### CANCELLATIONS & REFUNDS

At the time we receive written notice that you must cancel your trip, the following fees will apply based on land cost per person/per trip (all dates are from departure date):

### Days Prior to Departure

<b>Fee</b>	
From time of reservation until 45 days	Deposit
45 days or less	100% of Land Cost

Please note that some trips carry a different cancellation schedule as indicated on the invoice.

## ADDITIONAL BOOKING INFORMATION

<< *Continued from pg.3*

In this case, that cancellation policy supersedes the information above. Clients are strongly advised to purchase cancellation insurance at the time of making the booking, as this will cover cancellation charges in certain circumstances. Payments due at the time of cancellation remain the responsibility of the client.

### CANCELLATION BY KNOWMAD ADVENTURES

Knowmad Adventures reserves the right to cancel any trip due to inadequate sign-up or other cause that makes the trip unfeasible for us to operate, but we will inform you at least 45 days prior to departure. In such a case, the client may choose a full refund of the Land Cost or an alternative trip. If the alternative trip chosen by the client is of lesser or greater value than the tour originally booked then the client will be entitled to a refund of the price difference or be required to pay the price difference. Knowmad Adventures is not responsible for additional expenses incurred by members preparing for the trip (e.g. nonrefundable "Advance Purchase" air tickets, visa fees if applicable, clothing, equipment, medical expenses).

### UNUSED SERVICES

No partial refunds are possible for unused services including hotel rooms, air or land transport, trekking days, or other sight-seeing excursions.

### PRICES, SURCHARGES & BROCHURE VALIDITY

As we publish our prices more than a year in advance, we may occasionally be faced with significant cost increases due to factors over which we have no control. As such, we reserve the right to impose surcharges or price increases due to unfavorable exchange rates, increases in air fares or other transport costs, taxes, increases in the cost of services, or if government action should require us to do so. If any surcharge results in an increase of more than 10% of the tour cost excluding insurance premiums the client may cancel the booking within 14 days of notification of the surcharge and obtain a full refund. Prices and dates in the catalog are only indicative.

### MEDICAL & HEALTH

Good physical and mental health is essential for the enjoyment of these trips. By forwarding

the deposit, the client certifies that he/she does not have any physical or other conditions that would create a hazard for himself/herself or other travelers. Any client over the age of 65 or with preexisting medical conditions must complete a medical certificate. If the medical form cannot be completed for any reason and has not been returned by the client by the final payment date specified above, Knowmad Adventures reserves the right to treat the booking as cancelled by the client. Once a trip has been confirmed, medical conditions will not be considered as exceptions to the cancellation policy.

### FLEXIBILITY

Trip itineraries as stated for each tour are simply an indication of each trip's events and what the group may realize, and are not a contractual obligation. The client acknowledges that the nature of this type of travel requires significant flexibility and should allow for changes. The client understands that the amenities, type of transport, route, schedule, and itinerary may change without prior notice due to events or local circumstances, which may include but are not limited to mechanical breakdown, flight cancellations, illness, strikes, political disputes, weather, border crossing issues and other unforeseeable events.

### CHANGES BY KNOWMAD ADVENTURES

Knowmad Adventures does its best to operate all trips as advertised, however reasonable changes may be made to itineraries where considered necessary. Knowmad Adventures reserves the right to change any of the services and facilities described in the trip descriptions before a booking is made. If such a change is made, the client will be informed at the time of booking. If Knowmad Adventures makes a major change (a major change is defined as one that effects one day in a five day itinerary) after a client has booked, the company will inform the client as soon as possible if there is time before the departure. If the major change is due to force majeure or unforeseen circumstance, no refund or compensation is payable.

### TRANSFERS

Clients may transfer to another trip without a fee up to 90 days before departure on most trips. If you transfer from one trip to another within 89 days of departure, however, clients are subject to the usual Cancellation Fees outlined above. This transfer date corresponds with the date we receive notification of transfer in writing.

### RESPONSIBILITIES OF TRIP MEMBERS

Trip members have certain responsibilities to Knowmad Adventures and other trip members. The client must at all times comply with the laws, customs, foreign exchange and drug regulations of the countries visited. At all times the decision of the local guide or local supplier is final on all matters that may threaten the safety or interfere with the well being of the group or individual travelers. Should the client fail to comply with the above or jeopardize the well being of others or the group, then the local guide or local supplier may order the client to leave the trip without recourse to any refund.

### TRAVEL DOCUMENTS

The client must obtain and have possession of a valid passport and all visas, permits, and vaccination certificates required for the entire trip. The client accepts responsibility for obtaining these documents and any other necessary documents. Information or advice given by Knowmad Adventures on visas, vaccinations, climate, clothing, baggage, special equipment, etc. is given in good faith but without responsibility on the part of Knowmad Adventures.

### CLAIMS AND COMPLAINTS

If a client has a complaint against Knowmad Adventures, the client must first inform the local guide/supplier while on the trip in order that the guide/supplier can attempt to rectify the issue.

### INSURANCE

It is the responsibility of the client to obtain personal travel insurance. The client is willing to accept full responsibility for insurance up to limits that the client may require. This insurance must cover personal accident, medical expenses, air ambulance, loss of effects, repatriation costs and all other expenses which may arise as a result of loss, damage, injury, delay, or inconvenience occurring to the client. It is compulsory that all clients have travel related medical insurance. When the client purchases travel insurance arranged by Knowmad Adventures the client acknowledges that he or she is satisfied with the levels of insurance arranged by us. If the client does not purchase insurance through Knowmad Adventures, the client understands that the price of the trip does not include any insurance. When obtaining travel insurance from a source other than Knowmad Adventures, the client must make certain that the insurer is aware of the type of travel that the client will be undertaking.

### PHOTOGRAPHY

Knowmad Adventures may take photographs and/or video of its trips and participants grant Knowmad Adventures permission to do so and for it to use them for promotional or commercial use without payment or any compensation to the client.

### AIRLINES

The responsibility of Knowmad Adventures in respect to air travel is limited by the airlines conditions of carriage. Knowmad Adventures is not able to specify the type of aircraft to be used by any airline. In addition, Knowmad Adventures is not responsible for losses due to cancelled flights or seats or changed flight itineraries. The client cannot cancel the contract with Knowmad Adventures without penalty due to a change of airline, aircraft type or destination.

### CONTRACT

Anyone wanting to make a booking must complete the Registration Form and sign the Liability Release. The person(s) included on the Registration Form are referred to as the "client" in this document. All clients will be bound by the conditions in this document. All bookings are made with Knowmad Adventures, Inc., dba Knowmad Adventures, which sells the trips described in the brochure and website. No person has any authority on Knowmad Adventures' behalf to vary these booking conditions. The service to be provided is the trip(s) referred to in Knowmad Adventures brochure, website and discussed with its agents.